

TECHNICAL SPECIFICATIONS



- ➔ Ideal solution for mandatory hygiene needs.
- ➔ Thermometer and thermal camera adaptability.
- ➔ Compatible with all access control systems.



Laboratories



Amusement Parks

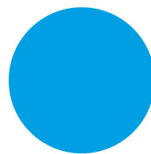

Kitchens



Public Transport

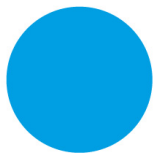
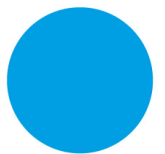

Food Processing Facilities



Collective Work and Living Places

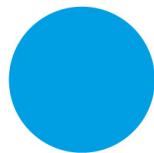

Factories



Canteens

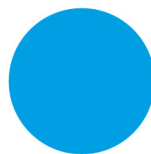

Gyms

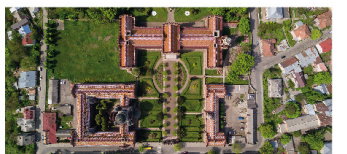
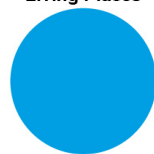

Campuses

**GENERAL SPECIFICATIONS**

<b>Power</b>	110/220 V – 60/50 Hz. AC (% ± 10), 24 V DC. ~4,4W (turnstile), ~1,8W (sanitizer unit)at stand-by. ~12W (turnstile), ~33W (sanitizer unit) max. during passage.
<b>General Dimensions</b>	750 x 1263 x 293 + 470 (arm length)mm
<b>Tank Area Dimensions</b>	205 x 295 mm
<b>Body Features</b>	304 grade (opt. 316 grade) stainless steel with orbital brushed matt (opt. satin brushed) pattern, 316 grade stainless steel sanitizer compartment.
<b>Arms</b>	Ø40 x 2 mm 304 grade (opt. 316 grade) stainless steel. Arms can be dismantled or mounted one by one separately.

# TECHNICAL SPECIFICATIONS

<b>Sanitizer Liquid Capacity</b>	5 + 5 lt two tanks (optional expandable capacity, tanks of different sizes and volumes can be used).
<b>Passage Capacity with 1 lt Sanitizer</b>	110 passages.
<b>Sanitizer Type</b>	liquid type (max. 50 mPa.s, 20°C), gel types can not be used.
<b>Operating Temperature, Humidity</b>	(-20°C) – (+68°C) (Opt.: - 50°C with heater positive), RH 95% (±2%) non-condensing. Specifications of sanitizer liquid supplier shall be considered additionally.

## SYSTEM FEATURES

<b>Indicators</b>	<p>Status and top passage indicators are available as standard.</p> <p>Status indicators: Green arrow-red cross indicating the status of the turnstile.</p> <p>Top passage indicators: At stand-by, if there is a card reader system, scan card indicator on indicator panel flashed green and turns to permanent green upon an approved card scan. If there is a temperature detection system, temperature measurement indicator flashes green and turns to permanent green upon an approved measurement.</p> <p>Upon approval from both systems, hand signs starts to flash in green and turns into permanent green upon inserting both hands into sanitizer compartments. Spraying starts and spraying LED's illuminates in blue.</p> <p>At the end of spraying top passage indicator flashes in green until passage completes.</p> <p>Illuminates red, gives audio signal and turnstile will not allow passage.</p>
<b>Control System</b>	Controlled by dry contact or grounding input. Optional RS232/RS485/TCP IP control module is available.
<b>Integration</b>	Compatible with all access control systems that provide dry contact or grounding outputs. Biometric, thermometer and thermal camera can be adapted.
<b>System Features</b>	<p>Besides working as only a hygiene turnstile, can also work with access control systems (thermometer, thermal camera, biometric and card readers).</p> <p>System allows passage of 1 person upon authorization from access control system and after sanitizing his hands.</p> <p>System automatically activates upon inserting hands into the sanitizing compartment made of 316 grade stainless steel and sanitizing process starts. Hands shall be kept inside sanitizing compartment during designated time, upon completion signal at the end of the time hands are pulled out and person completes the passages.</p> <p>System contains easy accessible 5+5 lt tank area (different liquid amounts may be available with different tank and options if required). Sanitizing liquid is drawn from these tanks by vacuum pumps and sprayed on the hand from multiple points.</p> <p>An alarm (audio-visual) is available for "out of liquid" situation. In such a case, systems gets into OFF mode, status indicators return to red cross and top passage indicators illuminate in red.</p>
<b>Time Out</b>	2-6-12 seconds or infinite, dipswitch selectable.
<b>Output Data</b>	System provides dry contact passage feedback by relays separately for each direction. System provides busy signal during passage.

# TECHNICAL SPECIFICATIONS

## FUNCTIONAL FEATURES

<p><b>Passages</b></p>	<p>The system grants access authorization for 1 person if the specified instructions are followed, otherwise system goes into alarm mode and restricts access.</p> <p>Besides working as only a hygiene turnstile, can also work with access control systems (thermometer, thermal camera, biometric and card readers). System allows passage of 1 person upon authorization from access control system and after sanitizing his hands.</p> <p>Passage algorithm can be adjusted according to the customers' requirements based on the command received from the sanitizing control unit and/or access control system and thermometer.</p>
<p><b>Flow Rate</b></p>	<p><b>Capacity of Mechanism</b>  <b>Standard Turnstiles :</b> Max.97 pass/minute, Nominal: 41 persons/minute.  <b>Motorized Turnstiles:</b> Max 48 pass/minute, Nominal: 29 persons/minute.                  System allows next passage in less than ~0,3 seconds.                  Turnstile with Sanitizer: 15-20 pass/minute.</p>
<p><b>Emergency Mode</b></p>	<p>In case of emergency or power failure, the arms rotate freely to allow rapid passage, fail safe as standard (opt. fail secure).</p>
<p><b>Safety</b></p>	<p>The safety instructions of the sanitizer fluid supplier must be followed.</p> <p>Use of sanitizer liquids that are suitable for hospitals and/or food processing facilities that does not contain perfumes and coloring additives is recommended .</p>

## CERTIFICATION

Compliance	CE, RoHS, TSEK
------------	----------------

## OPTIONAL ACCESSORIES AND APPLICATIONS

<p><b>Options</b></p>	<p>Automatic drop arm, motor driven unit, remote control units, manual control, counter, card reader pole, photocell alarm sensor, limiter, passive shoes sanitizer bottom plate, thermometer, thermal camera.</p>
-----------------------	--

TECHNICAL SPECIFICATIONS

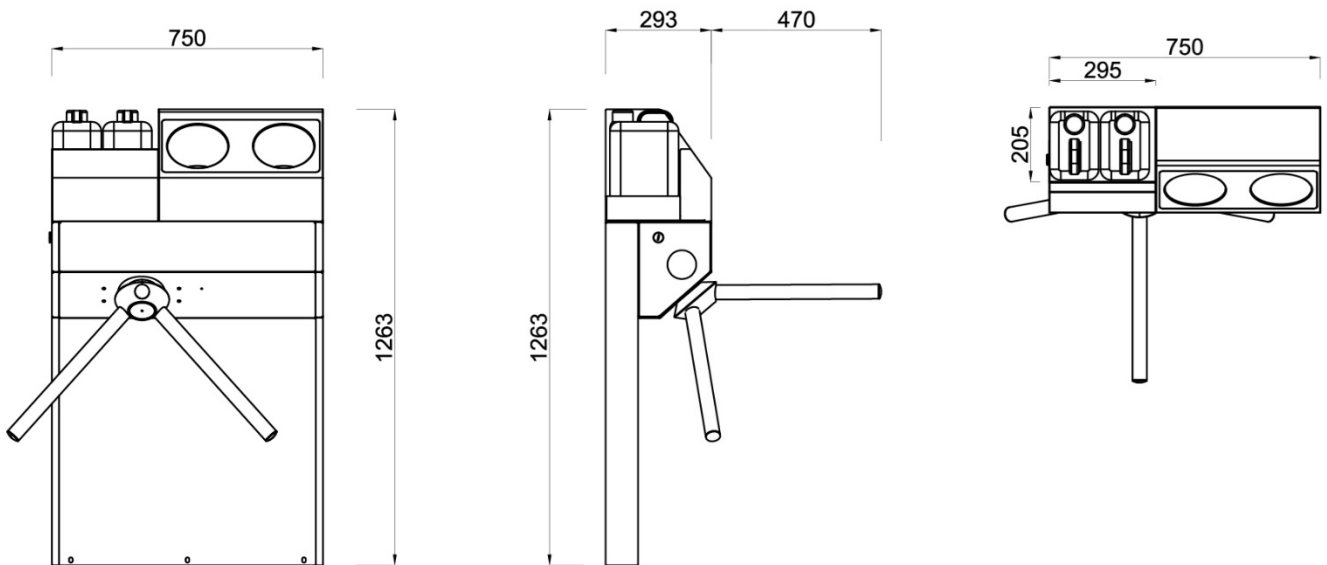
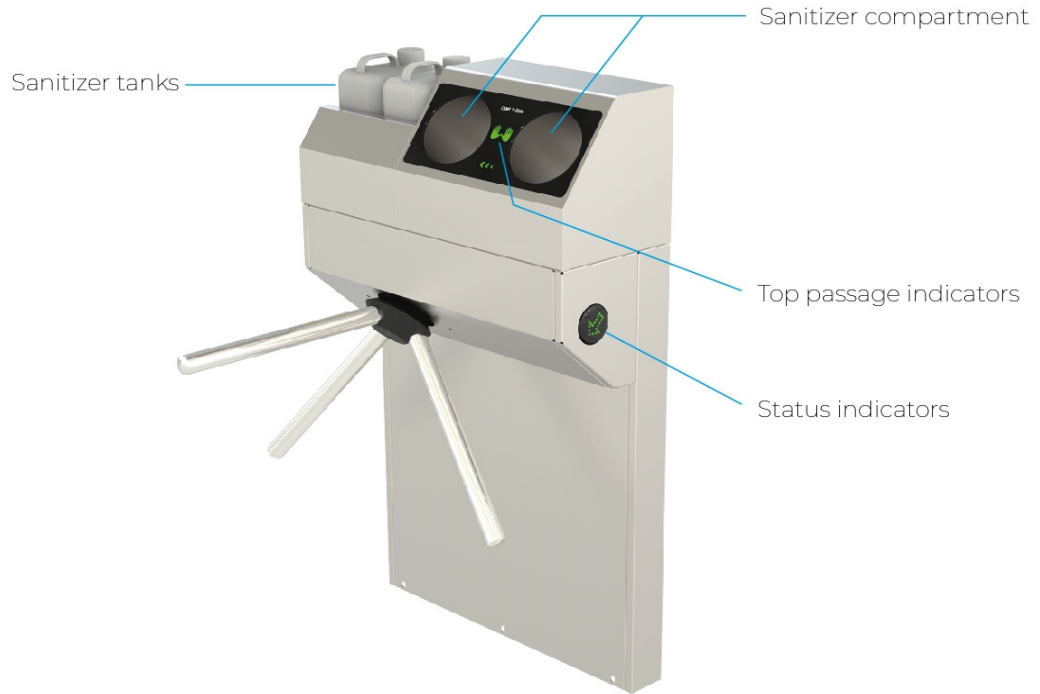

Design and specifications are subject to change without notice.