

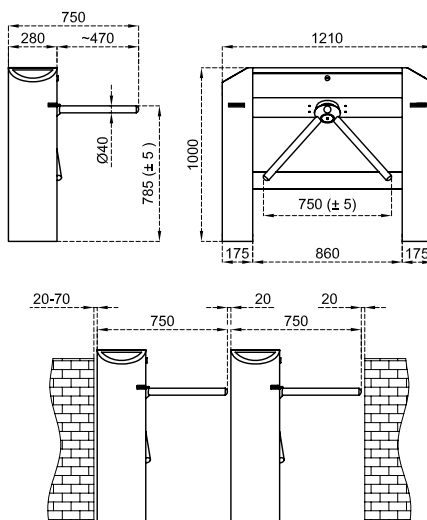





Dimensions (mm)



## Technical Features

<b>Place of Use</b>	Indoors, outdoors
<b>Operating Temperature, Humidity</b>	-20°C/+68°C (opt. -50°C with heater positive), RH 95% non-condensing..
<b>Operating Intensity</b>	100%, 7/24 use.
<b>Body Features</b>	<b>Material</b> : 304 grade (opt. 316 grade) stainless steel. <b>Finishing</b> : Orbital brushed matt (opt. electrostatic powder coating on stainless steel).
<b>Arms</b>	<b>Automatic Drop (Retractable) Arm</b> : Standard <b>Material</b> : Ø40x1,2 mm 304 grade (opt. 316 grade) stainless steel, one by one demountable. <b>Finishing</b> : Satine brushed (opt. orbital brushed matt, electrostatic powder coating on stainless steel).
<b>Indicators</b>	<b>Side Status /Direction Indicators</b> :   LED, standard. <b>Top Passage Indicator</b> :   LED, standard.
<b>Power</b>	<b>Operating Voltage</b> : 110/220V AC 50/60 Hz. (%±10), 24V DC. <b>Consumption</b> : ~3,4W at stand-by, during passage ~2,7W (varies according to the options and accessories used).
<b>Operating Modes</b>	System operates bi-directionally (entry-exit). Operating modes can be adjusted through the buttons and screen on the control card. Entry - exit controlled      Entry controlled, exit free      Entry free, exit controlled Single input both directions use      Entry - exit free
<b>Operating System</b>	Electromechanical motorized operation (opt. electromechanical manual operation).
<b>Control System</b>	All functions, parameters and operating modes can be adjusted through the buttons and screen on the control card. All inputs are opto-coupler protected. Controllable by dry contact (ground control). Compatible with all kinds of access control device. Optional RS232, RS485 or TCP/IP module is available.
<b>Flow Rate</b>	<b>Capacity of mechanism (manual)</b> : Max. 82 cycle/min. <b>Nominal</b> : ~30 pass/min. <b>Capacity of mechanism (motorized)</b> : Max. 75 cycle/min. <b>Nominal</b> : ~25 pass/min. (Passage rate can change depending on the access control system utilized)
<b>Emergency Mode</b>	System allows free passage (entry-exit) in both directions by the automatic drop arm (fail safe). Works compatible with fire warning and similar systems. At the end of an emergency situation, system returns to its normal operating mode.
<b>Power-off Situation</b>	System allows free passage (entry-exit) in both directions by the automatic drop arm (fail safe). Optionally, can be set (fail secure) as; entry-exit locked, entry free-exit locked, or entry locked-exit free. Free passage in chosen direction by manual override key in fail secure option is available.
<b>Weight</b>	~48 kg
<b>Optional Features and Accessories</b>	Wireless remote control (receiver-transmitter), manual control, manual override key (with fail secure option), coin slot and coin box, single/multiple intelligent coin/token slot and box, counter (with/without reset), card reader mounting bracket, photocell alarm sensor, passage completion sensor, contactless passage sensor, heater positive, top lid weight sensor, bottom plate, battery back-up, 316 grade stainless steel, RS232-RS485-TCP/IP modules, limiter, electrostatic powder coating on stainless steel, motorized card collector unit and card collection box.